

- Thermally Protected MOVs
- Surge Levels Available:
25 kA/Mode, 50kA/Phase
- ANSI/UL 1449 4th Edition, cUL
- Sine Wave Tracking: Type 2
- Surge Impulse Rated and Tested

- Inrush Current Limitation
- Starting and Peak Current Limitation
- Circuit Feedback Protection
- Harmonic Mitigation
- Reduction in Losses

- Monitor Under/Over voltage, Phase Loss, Imbalance
- Audible Alarm w/ disable switch, and LED indication
- Active Load Disconnect & Reset
- User Selectable Controls:
- +/- 5, 7.5, 10, 15, 20, 25% Over/Under Voltage Trip Settings
- Auto restart available with user selectable reset time. Includes: No delay, 5s, 10s, 30s, 1m, 5m, 10m, No restart

This “3-in-1” Power Quality System rigorously defends your essential equipment from damaging disruptions. If you are experiencing power quality anomalies that you have not been able to identify or remediate, or are continuously replacing equipment due to damage from a known process; this unit may provide the solution you have been looking for.



General Technical Specifications

Connection Type	Contactor and Line Reactor are Series
Voltage, Phase Configuration	120/240 Split Phase, (3W+G) 120/208V Three Phase Wye, (4W+G)* (127/220V Three Phase Wye, (4W+G))* (220/380V Three Phase Wye, (4W+G))* 277/480V Three Phase Wye (4W+G)** 240V Three Phase Delta (3W+G) 480V Three Phase Delta, (3W+G)
Maximum Continuous Operating Voltage	120V, 150 VAC (125%); 127V, 150 VAC (118%); 220V, 320 VAC (145%); 240V, 320 VAC; 277V, 320 VAC; 480V, 550 VAC; All Others 115%
Short Circuit Current Rating (SCCR)	200kAIC Surge; 22kAIC Contactor
Contactor Current Rating	30, 60, or 90 Amp (120V Supply Voltage)
Line Reactor Current Rating	30, 60, or 90 Amp (Typically matches Contactor)
Line Reactor Impedance	3% - 5%
Protection Modes	All Connected Modes: L-N, L-L, L-G, N-G
Operating Frequency Range	47 - 63 Hz
UL 1449 Location Type	Type 1 or Type 2
Nominal Discharge Current (In)	10 kA
Connection	Terminal Block, Rotary Disconnect, Line-Cord, or Wire Lead
Status Indication	Blue/Red LEDs, Form C, Audible Alarm w/ disable switch
Monitoring	Under Voltage/ Over Voltage + activation LED, Phase loss, Phase Imbalance
Enclosure	NEMA 4, 12, & 13 Rated (16 Gauge Steel)
50 Ohm EMI/RFI Attenuation	-50 db max(Type 2), -45db max(Type 1); from 10 kHz to 100MHz. The system provides up to 120dB insertion loss from 100 kHz to 100 MHz when used in a coordinated facility system.
Response Time	<0.5 nanoseconds
Operating Temperature	-40°C to +75°C
Operating Humidity	0% to 95% non-condensing
Weight	40 lbs
3-in-1 50kA/Phase Case Size	At least 16" x 16" x 8" - Larger may be required as size depends on bend needed for wire per NEC
Selectable Over/Under Voltage Trigger Levels	+/- 5%, 7.5%, 10%, 15%, 20%, 25%
Contactor Options for Auto Reset	Selectable resets: No Delay, 5s, 10s, 30s, 1m, 5m, 10m, No Restart
Warranty	SPD: 10 years Line Reactor: 5 Years

Minimum Enclosure Size

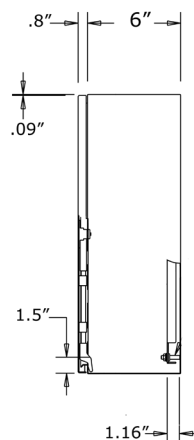
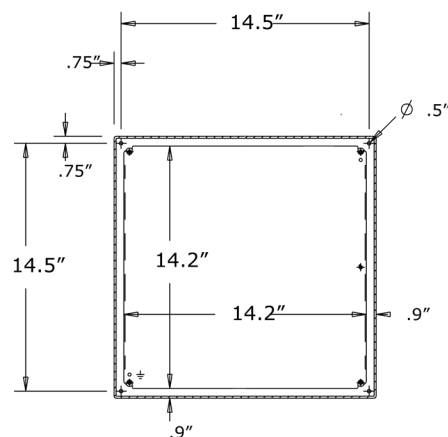
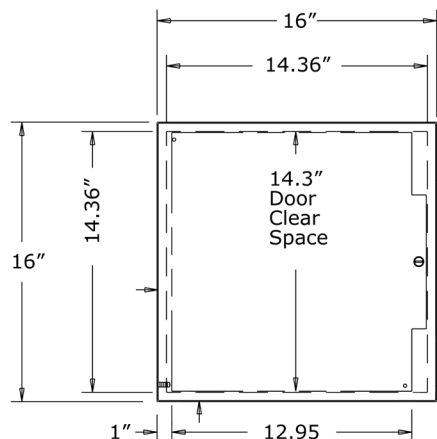

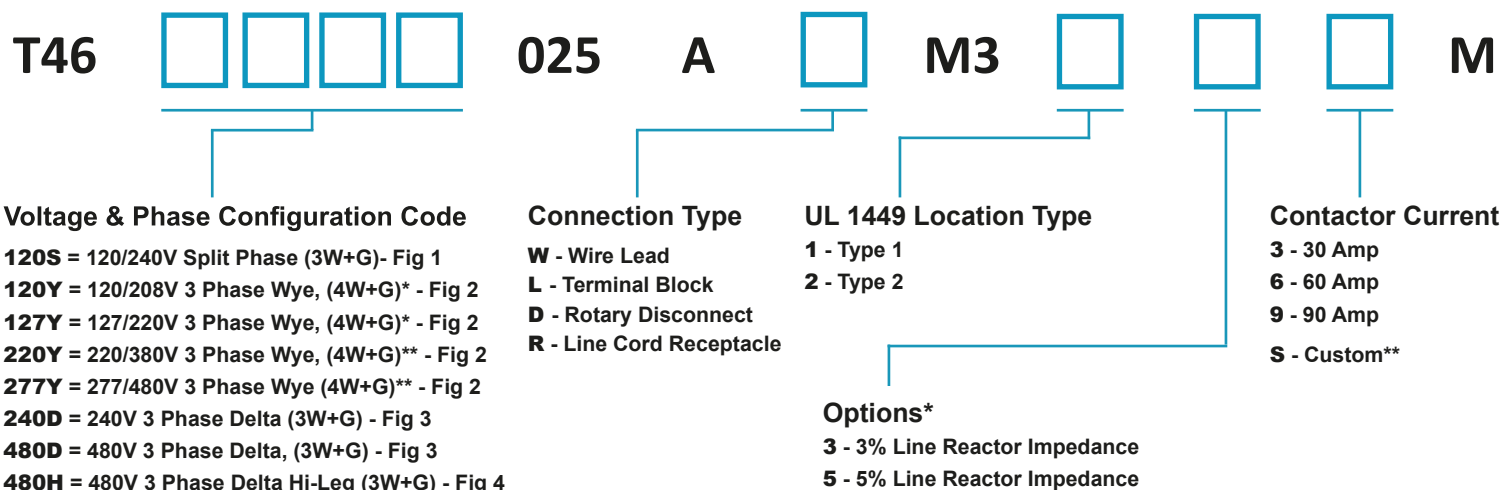

*This is a 120/208V unit, and can be used in 127/220V applications

**This is a 277/480V unit, and can be used in 220/380V applications

*Line Reactor Current Size will Match Contactor Current Size Selection in Position 17 of the product number.

**For custom sizes, place: "- ####" at the end of the product number
Example for 200A contactor:
T46120Y025ALM22SM-200

You may place the order as either part number.

Example Product number:

Filled in:

Complete:

T46 120Y 025 A L M3 2 5 3 M = T46120Y025ALM3253M

